

PRIMETAK DETAIL SEALANT OR LIQUID MEMBRANE APPLIED TO THE TOP EDGE OF TERMINATION BAR AND TO COVER MINIMUM 1/8" BEYOND PERIMETER OF FASTENER HEADS

PRIMETAK MEMBRANE APPLIED TO SUBSTRATE PREPARED WITH PRIMETAK LIQUID ADHESIVE, CALIFORNIA SEALANT OR ST LIQUID ADHESIVE AT A RATE OF 250 TO 300 SQ. FT. PER GALLON - OVERLAPS ARE 2 1/2" ON SIDE LAPS 6" ON END LAPS

PRIMETAK DETAIL SEALANT OR LIQUID ADHESIVE APPLIED TO SEAMS 12" FROM CHANGES IN PLANE, CONTINUOUSLY AND ALONG TERMINAL EDGES

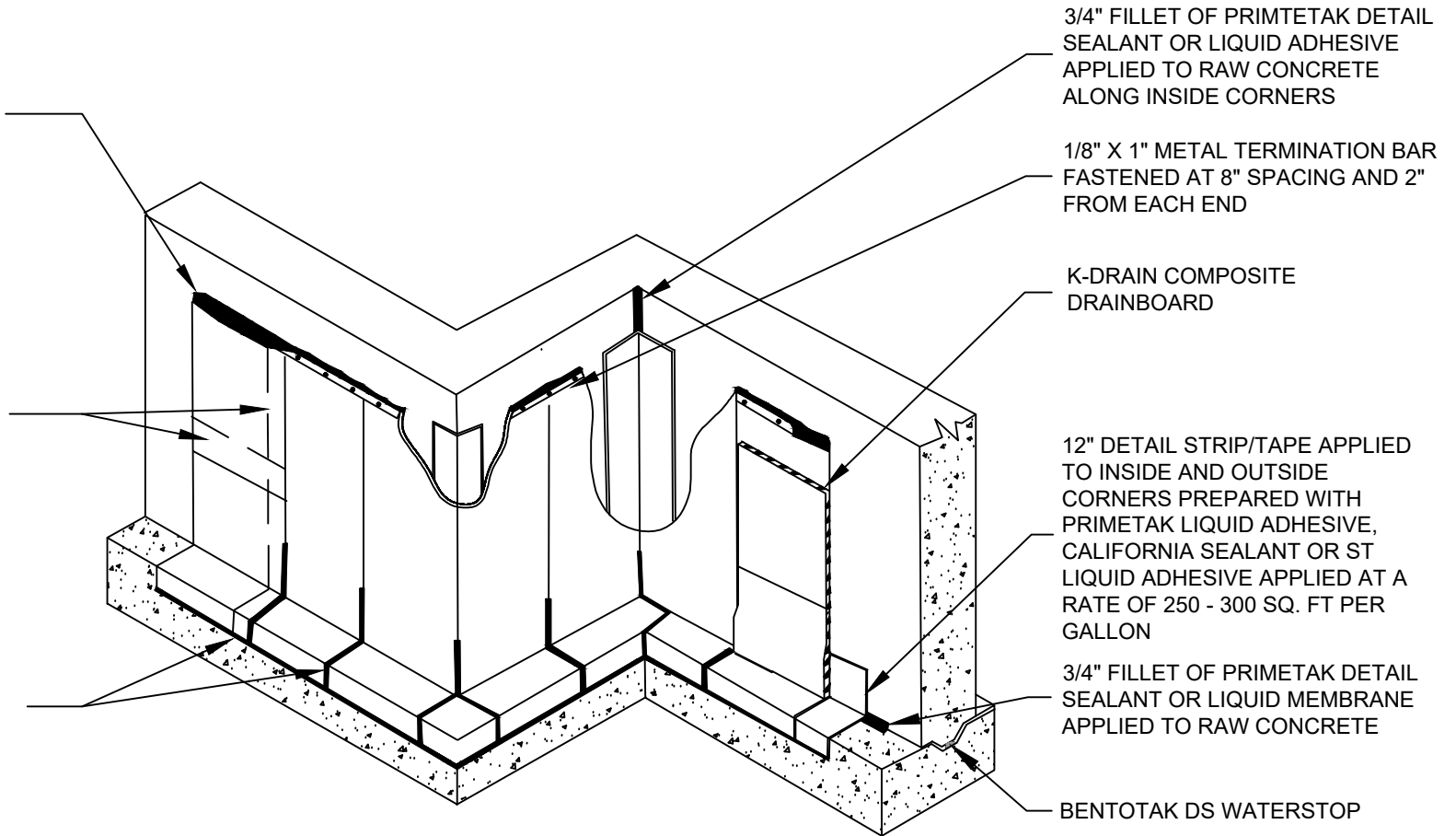

3/4" FILLET OF PRIMTETAK DETAIL SEALANT OR LIQUID ADHESIVE APPLIED TO RAW CONCRETE ALONG INSIDE CORNERS

1/8" X 1" METAL TERMINATION BAR FASTENED AT 8" SPACING AND 2" FROM EACH END

K-DRAIN COMPOSITE DRAINBOARD

12" DETAIL STRIP/TAPE APPLIED TO INSIDE AND OUTSIDE CORNERS PREPARED WITH PRIMETAK LIQUID ADHESIVE, CALIFORNIA SEALANT OR ST LIQUID ADHESIVE APPLIED AT A RATE OF 250 - 300 SQ. FT PER GALLON

3/4" FILLET OF PRIMETAK DETAIL SEALANT OR LIQUID MEMBRANE APPLIED TO RAW CONCRETE

BENTOTAK DS WATERSTOP

KINGFIELD
CONSTRUCTION PRODUCTS

20 N 4th St, Suite 300
Minneapolis, MN 55401
e: info@kingfieldcp.com
o/f: 612.225.5167

OVERVIEW@ PRIMETAK MEMBRANE VERTICAL WALL APPLICATION

SPECIAL NOTE: IF ADHESIVE IS REQUIRED FOR SEAMS OR ENDLAPS DO NOT USE ST LIQUID ADHESIVE

DRAWING NO. : PRI.03

SCALE : NOT TO SCALE

EFFECTIVE DATE : .