

PRIMETAK DETAIL SEALANT OR LIQUID MEMBRANE APPLIED TO THE TOP TERMINAL EDGE

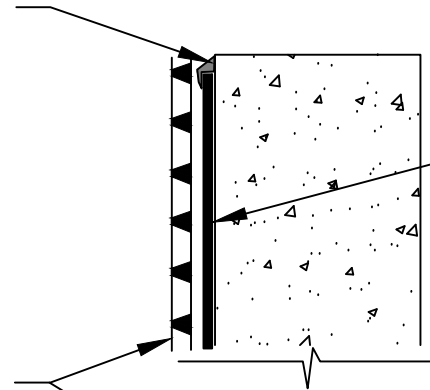

PRIMETAK MEMBRANE APPLIED TO SUBSTRATE PREPARED WITH PRIMETAK LIQUID ADHESIVE, CALIFORNIA SEALANT OR ST LIQUID ADHESIVE AT A RATE OF 250 TO 300 SQ. FT PER GALLON

K-DRAIN COMPOSITE DRAINBOARD - FABRIC FACING BACKFILL

1/8" X 1" METAL TERMINATION BAR FASTENED AT 8" SPACING AND 2" FROM EACH END - TERM BAR BY OTHERS

PRIMETAK DETAIL SEALANT OR LIQUID MEMBRANE APPLIED TO THE TOP OF THE TERMINATION BAR AND COVERING MINIMUM 1/8" BEYOND PERIMETER OF FASTENER HEADS

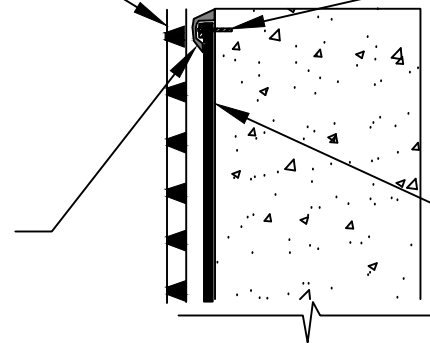

PRIMETAK MEMBRANE APPLIED TO SUBSTRATE PREPARED WITH PRIMETAK LIQUID ADHESIVE, CALIFORNIA SEALANT OR ST LIQUID ADHESIVE AT A RATE OF 250 TO 300 SQ. FT PER GALLON

KINGFIELD
CONSTRUCTION PRODUCTS

20 N 4th St, Suite 300
Minneapolis, MN 55401
e: info@kingfieldcp.com
o/f: 612.225.5167

SECTION @ TOP OF WALL TERMINATION OPTIONS

SPECIAL NOTE: IF ADHESIVE IS REQUIRED FOR SEAMS OR ENDLAPS DO NOT USE ST LIQUID ADHESIVE

DRAWING NO. : PRI.16

SCALE : NOT TO SCALE

EFFECTIVE DATE : .