

BUILD CMU WALLS WITH JOINTS ON THE WATERPROOFING SIDE STRUCK FLUSH WITH THE FACE OF THE CMU. EITHER PARGE COAT OR PREPARE THE SURFACE WITH A 60 MIL APPLICATION OF COMMERCIAL STRETCH

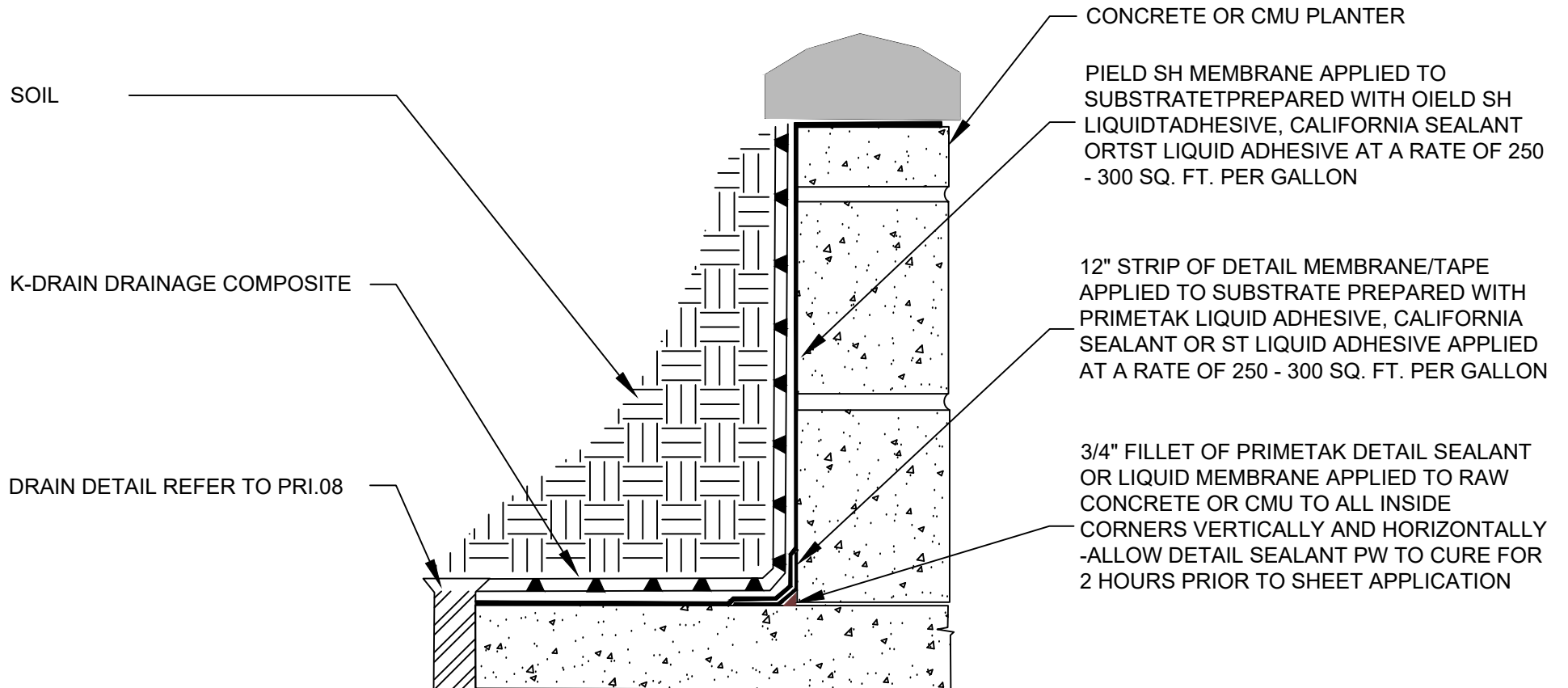

**KINGFIELD**  
 CONSTRUCTION PRODUCTS  
 20 N 4th St, Suite 300  
 Minneapolis, MN 55401  
 e: info@kingfieldcp.com  
 o/f: 612.225.5167

SECTION@ POURED CONCRETE OR CMU PLANTER WATERPROOFING

**SPECIAL NOTE: IF ADHESIVE IS REQUIRED FOR SEAMS OR ENDLAPS DO NOT USE ST LIQUID ADHESIVE**

DRAWING NO. :	PRI.02
SCALE :	NOT TO SCALE
EFFECTIVE DATE :	