



PRIMETAK MEMBRANE

60 MIL POLYMER MODIFIED RUBBERIZED ASPHALT PEEL-AND-STICK

PRIMETAK PEEL-AND-STICK WATERPROOFING MEMBRANE

Self-Adhesive Peel-and-Stick for Horizontal & Vertical Application

KEY FEATURES

- Factory bonding assures 60-mil uniform thickness
- Wide membrane width allows for fast and easy application, with reduced seams on continuous flat surfaces
- Detail Tape available for trim corners, construction joints, and other applications
- Release film to prevent tears
- Extended selvage edge for seam asphalt-to-asphalt adhesion
- White color to help reflect heat

APPLICATIONS

Concrete Foundation Walls
 Split Slabs
 Door & Windows Sills
 Tunnels
 Plaza Decks
 Parking Garages

COMPOSITION & MATERIALS

Kingfield's PRIMETAK Membrane is a 60 mil strong, pliable, self-adhesive sheet consisting of a 4 mil cross-laminated, high-density polyethylene (HDPE) backing, bonded to 56 mils of rubberized asphalt waterproofing compound.

PRIMETAK Membrane is produced in both summer- and winter-grade formulations; use PRIMETAK Membrane for ambient and substrate surface temperatures of 40°F (4°C) and rising, use PRIMETAK Membrane Winter for ambient and substrate surface temperatures of 25°F (-4°C) to 65°F (18°C).

BASIC USES

PRIMETAK Membrane is used on concrete foundation walls, split slabs, sills and spandrel beams, tunnels, plaza decks, parking garages and related applications where waterproofing is critical. Kingfield's PRIMETAK Membrane may also be used on wood, concrete masonry (CMU) structures and Insulated Concrete Forms (ICF).

Kingfield PRIMETAK Membrane conforms to the following specifications:

- Corps of Engineers CEGS-0711 AIA
- Federal Construction Guide FCGS 07111
- Department of the Navy NAV FAC TS 07111
- Veterans Administration 14-08-1 Section 07311
- MasterSpec Section 07111
- General Service Administration PBS (PCD) 07111
- American Railway Engineering Association (AREA) 29-2

PROPERTY	TEST METHOD	TYPICAL VALUE
FILM COLOR		Black/White
MEMBRANE THICKNESS	ASTM D 1000	60 mils
TENSILE STRENGTH - MEMBRANE	ASTM D 412 Modified Die C	370 PSI
ELONGATION - ULTIMATE FAILURE OF RUBBERIZED ASPHALT	ASTM D 412	600%
TENSILE STRENGTH - FILM	ASTM D 882	7294 PSI
PERMEANCE	ASTM E 96 Method B	0.022 Perms
CRACK CYCLING	ASTM C 836 Tested @-15°F (-26°C)	No effect
PEEL ADHESION	ASTM D 903	17 lbs./in. width
LAP PEEL ADHESION	ASTM D 1876	8.0 lbs./in. width
LOW TEMPERATURE FLEXIBILITY (-15°F)	ASTM D 1970 Modified	Pass
PLIABILITY	ASTM D 146 180° bend over 1" mandrel at -25°F (-32°C)	No effect
PUNCTURE RESISTANCE - MEMBRANE	ASTM E 154	69 lbs.
RESISTANCE TO HYDROSTATIC HEAD	ASTM D 5385	231 ft.
EXPOSURE TO FUNGI IN SOIL	GSA-PBS 07115 (16 weeks)	No effect
WATER ABSORPTION	ASTM D 570	0.1%

INFO@KINGFIELDCP.COM – 612.225.5167 – WWW.KINGFIELDCP.COM

KINGFIELD CONSTRUCTION PRODUCTS – 20 NORTH 4TH STREET, SUITE 300, MINNEAPOLIS, MINNESOTA 55401

The information contained herein is believed by Kingfield Construction Products to be accurate and is offered solely for the customer's consideration, investigation, and verification. Determination of suitability for use is the responsibility of the user. Kingfield's Limited Warranty, & Disclaimer along with Standard Terms & Conditions apply. See www.kingfieldcp.com for more info. Limitations: Standard variations of mechanical properties and hydraulic properties are normal. Kingfield products are resistant to chemicals in normal soil environments, however some reagents may affect the performance of these products. A Kingfield representative should be contacted for further information to determine the suitability of use of these products in unusual soil environments. Unless otherwise stated, Kingfield products should have limited exposure to artificial UV and sunlight. Kingfield products should be protected immediately, and if applicable, backfilled or covered within seven days of installation. Disclaimer: All information, drawings and specifications are based on the latest published information at the time of printing. Kingfield reserves the right to make changes due to manufacturing improvements and engineering at any time. All physical properties are minimum average values (MAV).

INSTALLATION

SURFACE PREPARATION

- Prior to starting work, check that all horizontal surfaces to be waterproofed slope towards drainage or refer to balcony details for zero-slope applications. This material is not designed to be applied in areas where water will pond.
- A smooth monolithic concrete surface is required. Provide a Concrete Surface Profile (CSP) 1 thru 3. Broom surfaces are not recommended.
- Concrete should be dry, frost free and cured a minimum of seven days prior to application of PRIMETAK membrane and PRIMETAK LIQUID ADHESIVE.
- Surface must be free of voids, spalled areas, sharp projections, loose aggregate and form release agents.
- Do not use concrete curing compounds containing oil, wax or pigments.
- Form release agents must be the self-dissipating type which will not transfer to the membrane.
- Surface defects; such as cracks, single bug holes of 1/2- inch or greater, or cavities; should be filled and finished flush with a Portland cement grout or concrete. Single bug holes can also be filled with PRIMETAK DETAIL SEALANT or Kingfield's SEPA SEAL 5000 detailing sealant.
- Finish below-grade (except footings) and the top of projecting ledge surfaces to a beveled or rounded edge.
- Striking off joints flush with surface is also required. Concrete masonry walls or brick with deeply recessed mortar joints require a well-adhered parge coat before application of membrane.
- Clean all surfaces to remove debris, dust and loose stones before application begins. DO NOT apply system to frozen concrete.

Penetration/Inside Corner/Fillet/Detail Liquid Membrane

PRIMETAK DETAIL SEALANT: Single-component tube or pail.

- Apply fillets formed by PRIMETAK DETAIL SEALANT, latex modified cement mortar, or epoxy mortar at the base of foundation walls, footings, and inside corners. Provide a 3/4" fillet face.
- DO NOT use wood or fiber cant strips.
- DO NOT prime underneath PRIMETAK DETAIL SEALANT when applied to concrete.
- Cover all inside corners and the base of the foundation wall to footing joint using a 12-inch wide strip of PRIMETAK DETAIL TAPE centered along the axis. Press or roll firmly to achieve a complete seal. PRIMETAK DETAIL SEALANT may be substituted for the initial 12-inch wide strip of PRIMETAK DETAIL TAPE on inside corners by applying a minimum of 90 mils, 3/4" fillet (cant) 6" vertically and horizontally away from the fillet (cant).
- At penetrations, posts, or projections, seal with PRIMETAK DETAIL SEALANT 6 inches onto concrete and 3-inches onto penetrating item; then apply a second flashing sheet over the penetration extending a minimum of 6 inches from the detail. The seal the cut edges of all terminations must be sealed with PRIMETAK DETAIL SEALANT.
- Treat drains and projections with a second ply of PRIMETAK Membrane for a distance of 6" away from drain or projection. Seal all terminations with PRIMETAK DETAIL SEALANT.
- Complete detail work prior to applying PRIMETAK LIQUID ADHESIVE or PRIMETAK ST LIQUID ADHESIVE. PRIMETAK DETAIL SEALANT can be used for detailing penetrations, allowing a minimum 2 hours to cure prior to waterproofing membrane application.
- Pipes which are wired together and touching, cannot properly be waterproofed. Ensure all pipes have proper spacing. Recommended spacing for pipe penetrations is 2-inches. The minimum allowed is 1-inch.

Priming

Stir PRIMETAK LIQUID ADHESIVE or PRIMETAK ST LIQUID ADHESIVE before use.

- PRIMETAK LIQUID ADHESIVE or PRIMETAK ST LIQUID ADHESIVE provides a tacky adhesive surface.
- PRIMETAK LIQUID ADHESIVE or PRIMETAK ST LIQUID ADHESIVE should be applied over the entire surface at a rate of 250-300 square feet per gallon.
- Re-prime if membrane is not applied to the Liquid Adhesive within the same working day.
- Use brush or sort nap lamb's wool roller for Liquid Adhesive application.
- Liquid Adhesive must be tacky to touch, but not wet, prior to application of PRIMETAK Membrane.
- Metal surfaces may require Liquid Adhesive to obtain bond of membrane to substrate.
- Field test to determine adhesion to substrate(s) prior to PRIMETAK Membrane application.
- Tack or cure for these products is totally dependent on relative humidity, ambient temperature, and substrate surface temperature.

Sheet Membrane

Apply Kingfield PRIMETAK Membrane in any width up to 48-inches. Side laps must be a minimum of 2-1/2 inches. Staggered end laps should be minimum 6 inches.

When applying Kingfield PRIMETAK Membrane on vertical walls, a determined effort must be made to assure complete adhesion of membrane to the primed surface. Use heavy hand pressure while smoothing out the membrane surface as it is applied. Roll installed membrane with a hand roller to ensure complete bond.

On horizontal surfaces, apply membrane from low to high pitch for maximum drainage. Use a minimum 75 lb. linoleum roller to roll membrane immediately after application, with special attention at overlaps and "T- Joints". Seal all end laps with PRIMETAK DETAIL SEALANT or SEPA SEAL 5000.

INFO@KINGFIELDCP.COM – 612.225.5167 – WWW.KINGFIELDCP.COM

KINGFIELD CONSTRUCTION PRODUCTS – 20 NORTH 4TH STREET, SUITE 300, MINNEAPOLIS, MINNESOTA 55401

The information contained herein is believed by Kingfield Construction Products to be accurate and is offered solely for the customer's consideration, investigation, and verification. Determination of suitability for use is the responsibility of the user. Kingfield's Limitations, Limited Warranty, & Disclaimer along with Standard Terms & Conditions apply. See www.kingfieldcp.com for more info. Limitations: Standard variations of mechanical properties and hydraulic properties are normal. Kingfield products are resistant to chemicals in normal soil environments, however some reagents may affect the performance of these products. A Kingfield representative should be contacted for further information to determine the suitability of use of these products in unusual soil environments. Unless otherwise stated, Kingfield products should have limited exposure to artificial UV and sunlight. Kingfield products should be protected immediately, and if applicable, backfilled or covered within seven days of installation. Disclaimer: All information, drawings and specifications are based on the latest published information at the time of printing. Kingfield reserves the right to make changes due to manufacturing improvements and engineering at any time. All physical properties are minimum average values (MAV).

When vertical walls that are more than 8-feet high, which are to be waterproofed, apply PRIMETAK Membrane in sections no longer than 8-feet, starting from the lower foundation base and rising to the top with the 6-inches overlap, shingling down on each ply of membrane. Apply Kingfield PRIMETAK Membrane on the horizontal footing and terminated with PRIMETAK DETAIL SEALANT. If the footing is smooth and otherwise properly prepared, it is acceptable to extend the PRIMETAK Membrane down the exterior face of the footing and terminate with PRIMETAK DETAIL SEALANT. Follow these measures for membrane termination when bottom of interior floor height is:

- Even to 6": Apply PRIMETAK Membrane across the top of footer and terminate on vertical face of footer, sealing terminal edge with PRIMETAK DETAIL SEALANT. For a poured-in-place footer, terminate the membrane within 3" of outer edge and finish with a termination (term) bar. Seal term bar, fasteners and terminal edge of membrane with PRIMETAK DETAIL SEALANT.
- 6" – 12": Terminate PRIMETAK Membrane on top of footer a minimum of 12 inches, and seal with PRIMETAK DETAIL SEALANT. Vertical face terminations are preferred.
- 12-inches or higher: Terminate PRIMETAK Membrane at vertical-to-horizontal juncture and seal with PRIMETAK DETAIL SEALANT.

Complete the upper terminating edge of Kingfield PRIMETAK Membrane applied to a vertical wall over the top of the wall. If terminated on the vertical surface, use a reglet, counter flashing or termination bar. Firmly press the terminated edge with a hand roller, and protect with a troweled bead of PRIMETAK DETAIL SEALANT or SEPA SEAL 5000 detailing sealant.

Properly seal static cracks more than 1/16-inch wide on horizontal or vertical surfaces in accordance with the sealant manufacturer's instruction, apply a 12-inch wide strip of PRIMETAK Membrane.

Seal cold joints, T-Joints, and evident working cracks, with joint fillers, water-stop or sealant. Place a 12-inch strip of PRIMETAK Membrane centered directly over and along the crack. Overlay the 12-inch strip with the PRIMETAK Membrane field application, providing double strength at the area of movement.

PRIMETAK Membrane does not function as an expansion joint material, only as a waterproofing cover for expansion joint materials. All expansion joints should be properly sealed with joint fillers or an expansion joint as primary waterproofing. Then apply an 8" inverted piece of PRIMETAK Membrane centered over and across the joint, followed by a 12" strip adhered directly over joint. Full width PRIMETAK Membrane should follow. Construction joints, control joints, and cold joints should be sealed with joint fillers and PRIMETAK DETAIL TAPE, then apply PRIMETAK Membrane over the joint.

INSPECTION AND REPAIRS

Visually inspect membrane for tears, punctures, air blisters, and "fishmouths," prior to water tests, placement of protection board, and backfilling. Make repairs by removing all damaged membrane so only well-bonded PRIMETAK Membrane remains. Re-prime any exposed concrete. After Liquid Adhesive is dry, apply a new sheet of membrane over the concrete, extending 6-inches onto previously-applied PRIMETAK Membrane. Care should be taken to obtain good adhesion between membrane used for repairs and originally-applied PRIMETAK Membrane. Seal edges with PRIMETAK DETAIL SEALANT or SEPA SEAL 5000 detailing sealant.

"FISHMOUTH" REPAIR: Slit all "fishmouths," overlap the pieces, place patch over area and roll in place. Puncture air blisters, expel the air, prime and cover with patch. Extend the patch material minimum 6 inches in all directions beyond the repair area, then seal the patch edges with PRIMETAK DETAIL SEALANT or SEPA SEAL 5000 detailing sealant.

MEMBRANE TERMINATION

Apply PRIMETAK DETAIL SEALANT at all terminations at the end of each day's work. PRIMETAK DETAIL SEALANT should be allowed to cure 2 hours when used under the PRIMETAK Membrane.

MEMBRANE PROTECTION/DRAINAGE BOARDS

Protection board is required over PRIMETAK Membrane. Extruded polystyrene is acceptable for vertical applications. K-DRAIN drainage boards can be used in place of protection board. Use 1/8-inch Asphalt Protection Board to protect membrane on horizontal surfaces subject to normal construction traffic. Use 1/4-inch Asphalt Protection Board to protect the membrane on horizontal surfaces subject to heavy construction traffic. Apply protection board systems according to the manufacturer's application and guide specifications.

Membrane surfaces should be free of stones and dirt prior to protection board installation. When adhering protection board systems to Kingfield PRIMETAK Membrane, use a Kingfield approved adhesive system. Spot adhesion, rather than full adhesion, should be used so that in the event of backfill settlement exerting downward pressure, the protection system will detach from the membrane and slip downwards.

Drainage Board

Typically, for Horizontal & Vertical surfaces, use K-DRAIN 400 Drainage Board. Consult Kingfield for project specific recommendations.

Drainage Systems

Drain tile perimeter drainage system should have appropriate connectors and outlets.

Backfill Requirements

No waiting is required before backfilling. Backfill material should be select fill free of large dirt clods, rock, tree roots and debris. A fill type readily compactable upon deposit and able to be compacted per project specifications in 12-inch lifts. Fill should not have a high water content that would cause the soil to shrink upon drying. Use mechanical compaction in horizontal layers to achieve these results.

Topping Systems Requirements

Kingfield recommends a flood test or appropriate leak detection methods for all horizontally applied areas.

INFO@KINGFIELD.PC.COM – 612.225.5167 – WWW.KINGFIELD.PC.COM

KINGFIELD CONSTRUCTION PRODUCTS – 20 NORTH 4TH STREET, SUITE 300, MINNEAPOLIS, MINNESOTA 55401

The information contained herein is believed by Kingfield Construction Products to be accurate and is offered solely for the customer's consideration, investigation, and verification. Determination of suitability for use is the responsibility of the user. Kingfield's Limitations, Limited Warranty, & Disclaimer along with Standard Terms & Conditions apply. See www.kingfieldpc.com for more info. Limitations: Standard variations of mechanical properties and hydraulic properties are normal. Kingfield products are resistant to chemicals in normal soil environments, however some reagents may affect the performance of these products. A Kingfield representative should be contacted for further information to determine the suitability of use of these products in unusual soil environments. Unless otherwise stated, Kingfield products should have limited exposure to artificial UV and sunlight. Kingfield products should be protected immediately, and if applicable, backfilled or covered within seven days of installation. Disclaimer: All information, drawings and specifications are based on the latest published information at the time of printing. Kingfield reserves the right to make changes due to manufacturing improvements and engineering at any time. All physical properties are minimum average values (MAV).

STORAGE AND HANDLING

Material Handling

Membrane and accessories should be unloaded and stored carefully. Protect cartons and containers from weather, sparks, flames, excessive heat, cold and lack of ventilation. DO NOT stack membrane material higher than 5-feet vertically, nor double stack pallets. Store cartons on pallets and cover to prevent water damage. For best results, store membrane above 50°F (10°C) prior to application.

PRECAUTIONS

- PRIMETAK LIQUID ADHESIVE and PRIMETAK ST LIQUID ADHESIVE is an industrial coating and would be harmful or fatal if swallowed. It is marked as red label from the stand-point of flash point.
- Prohibit flames, sparks, welding and smoking during application.
- Refer to product label for handling, using and storage precautions.
- Solvents could be irritating to the eyes; flush with water and contact physician.
- Avoid prolonged contact with skin and breathing of vapor or spray mist from liquid adhesive. In confined areas, use adequate forced ventilation, fresh air masks, explosion-proof equipment and clean clothing.
- Avoid solvent contact with light bulbs or other high temperature surfaces.

Ultraviolet Protection

PRIMETAK Membrane is adversely affected by ultraviolet light. Cover the waterproofing system as soon as possible; DO NOT leave exposed to sunlight for over 30 days.

SAFETY

SDS documents for all Kingfield products can be obtained at www.kingfieldcp.com. Call Kingfield Construction Products at (612) 225-5167 with questions.

WARRANTY

We, the manufacturer, warrant only that this product is free of defects, since many factors which affect the results obtained from this product are beyond our control; such as weather, workmanship, equipment utilized and prior condition of the substrate. We will replace, at no charge, proven defective product within twelve (12) months of purchase, provided it has been applied in accordance with our written directions for uses we recommended as suitable for this product. Proof of purchase must be provided. An extended year material or system warranty may be available upon request. Contact Kingfield Construction Products for further details.

TECHNICAL SERVICES

Technical assistance and product information are available through a contacting Kingfield Construction Products via email (info@kingfieldcp.com) or by fax/phone (612) 225-5167

PACKAGING	PART NUMBER	UNIT SIZE	UNITS PER PALLET	UNIT WEIGHT
PRIMETAK MEMBRANE	PRIME-M	4' x 50' roll	25 rolls	75 pounds (roll)
PRIMETAK MEMBRANE WINTER	PRIME-M-W	4' x 50' roll	25 rolls	75 pounds (roll)
Required Accessories:				
PRIMETAK DETAIL TAPE	PRIME-DT	1' x 50' rolls (4/carton)	25 cartons	75 pounds (carton)
PRIMETAK DETAIL TAPE WINTER	PRIME-DT-W	1' x 50' rolls (4/carton)	25 cartons	75 pounds (carton)
PRIMETAK LIQUID ADHESIVE (Primer)	PRIME-LA-5	5-gallon pail	36 pails	45 pounds (pail)
PRIMETAK LIQUID ADHESIVE (Primer)	PRIME-LA-1	4 – 1 gal pails/carton	54 cartons	31 pounds (carton)
PRIMETAK ST LIQUID ADHESIVE (Primer)	PRIME-STLA-5	5-gallon pail	36 pails	44 pounds (pail)
PRIMETAK ST LIQUID ADHESIVE (Primer)	PRIME-STLA-1	4 – 1 gal pails/carton	54 cartons	37 pounds (carton)
PRIMETAK DETAIL SEALANT	PRIME-DS-20	20 sausages/carton	45 cartons	45 pounds (carton)
PRIMETAK DETAIL SEALANT	PRIME-DS-3	3-gallon pail	36 pails	37 pounds (pail)
PRIMETAK LIQUID MEMBRANE	PRIME-LM	2-gallon pail	80 pails	20 pounds (pail)
Drainage Composite Accessories:				
K-DRAIN 300	KD-300	4' x 75' roll	9 rolls	70 pounds (roll)
K-DRAIN 302	KD-300	4' x 75' roll	7 rolls	80 pounds (roll)
K-DRAIN 400	KD-400	4 – 6.5 – 8' x 50' roll	7 rolls	39 – 63 – 78 pounds (roll)
K-DRAIN 400 XL	KD-400-XL	4 – 6.5 – 8' x 50' roll	7 rolls	45 – 73 – 90 pounds (roll)
K-DRAIN 420	KD-420	4 – 6.5 – 8' x 50' roll	7 rolls	40.5 – 65.5 – 80 pounds (roll)
K-DRAIN 420 XL	KD-420-XL	4 – 6.5 – 8' x 50' roll	7 rolls	46.5 – 75.5 – 93 pounds (roll)
K-DRAIN 700	KD-700	4 -or- 8' x 50' roll	7 rolls	50 -or- 100 pounds (roll)
K-DRAIN 720	KD-720	4 -or- 8' x 50' roll	7 rolls	50 -or- 100 pounds (roll)
K-DRAIN 740	KD-740	4 -or- 8' x 50' roll	7 rolls	50 -or- 100 pounds (roll)
K-DRAIN 760	KD-760	4 -or- 8' x 50' roll	7 rolls	50 -or- 100 pounds (roll)
K-DRAIN 780	KD-780	4 -or- 8' x 50' roll	7 rolls	50 -or- 100 pounds (roll)
K-DRAIN 990	KD-990	4' x 50' roll	7 rolls	52 pounds (roll)
K-DRAIN 1000	KD-1000	4' x 50' roll	9 rolls	55 pounds (roll)

INFO@KINGFIELDCP.COM – 612.225.5167 – WWW.KINGFIELDCP.COM

KINGFIELD CONSTRUCTION PRODUCTS – 20 NORTH 4TH STREET, SUITE 300, MINNEAPOLIS, MINNESOTA 55401

The information contained herein is believed by Kingfield Construction Products to be accurate and is offered solely for the customer's consideration, investigation, and verification. Determination of suitability for use is the responsibility of the user. Kingfield's Limited Warranty, & Disclaimer along with Standard Terms & Conditions apply. See www.kingfieldcp.com for more info. Limitations: Standard variations of mechanical properties and hydraulic properties are normal. Kingfield products are resistant to chemicals in normal soil environments, however some reagents may affect the performance of these products. A Kingfield representative should be contacted for further information to determine the suitability of use of these products in unusual soil environments. Unless otherwise stated, Kingfield products should have limited exposure to artificial UV and sunlight. Kingfield products should be protected immediately, and if applicable, backfilled or covered within seven days of installation. Disclaimer: All information, drawings and specifications are based on the latest published information at the time of printing. Kingfield reserves the right to make changes due to manufacturing improvements and engineering at any time. All physical properties are minimum average values (MAV).

Common Kingfield Primetak Membrane Applications

These diagrams are not intended to be application instructions, simply illustrations

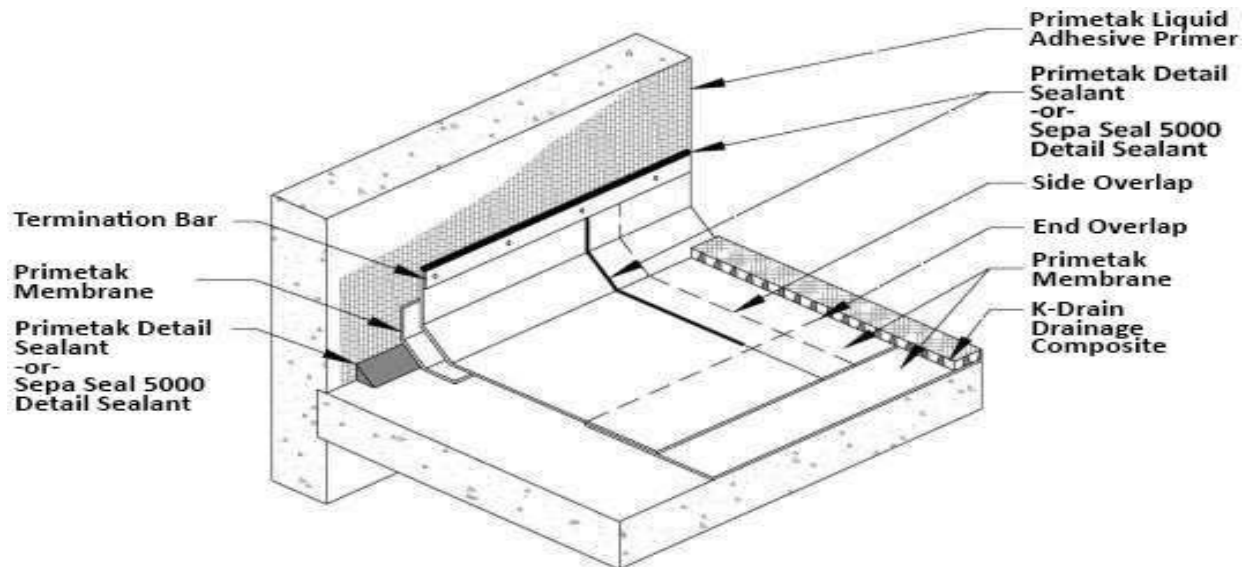

Primetak Membrane Horizontal Slab - Wall Termination

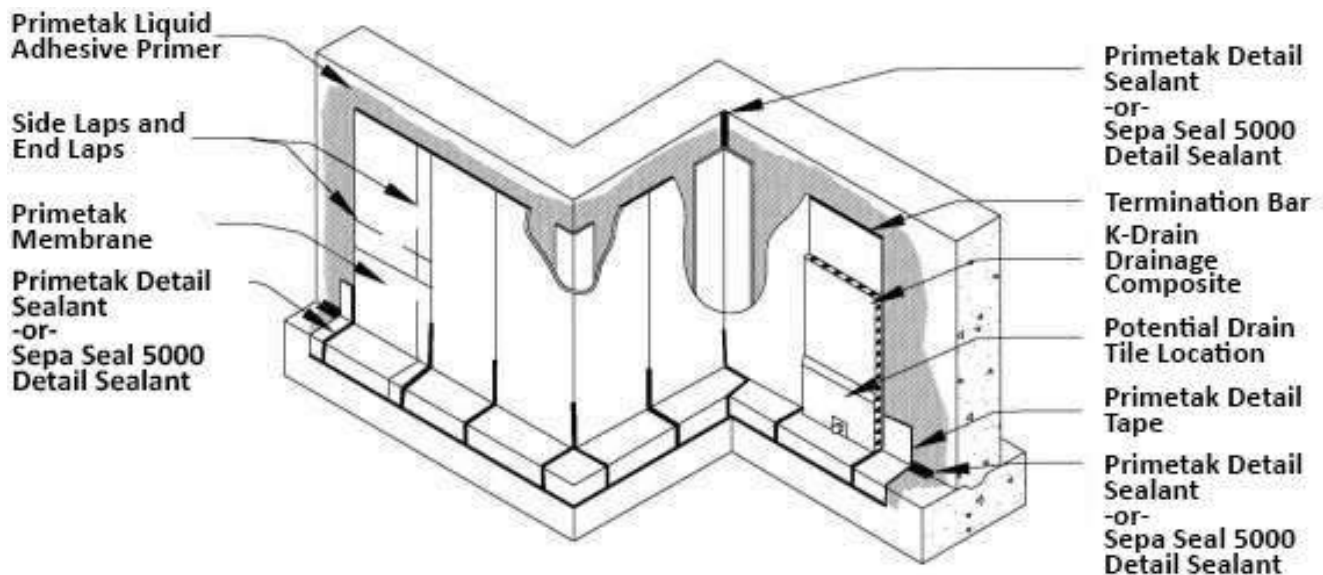

Primetak Membrane Vertical Wall Application

Please Note: Not intended to be full details. For full application detail on these configurations, contact Kingfield Construction Products or download them at www.kingfieldcp.com

INFO@KINGFIELDCP.COM – 612.225.5167 – WWW.KINGFIELDCP.COM

KINGFIELD CONSTRUCTION PRODUCTS – 20 NORTH 4TH STREET, SUITE 300, MINNEAPOLIS, MINNESOTA 55401

The information contained herein is believed by Kingfield Construction Products to be accurate and is offered solely for the customer's consideration, investigation, and verification. Determination of suitability for use is the responsibility of the user. Kingfield's Limitations, Limited Warranty, & Disclaimer along with Standard Terms & Conditions apply. See www.kingfieldcp.com for more info. Limitations: Standard variations of mechanical properties and hydraulic properties are normal. Kingfield products are resistant to chemicals in normal soil environments, however some reagents may affect the performance of these products. A Kingfield representative should be contacted for further information to determine the suitability of use of these products in unusual soil environments. Unless otherwise stated, Kingfield products should have limited exposure to artificial UV and sunlight. Kingfield products should be protected immediately, and if applicable, backfilled or covered within seven days of installation. Disclaimer: All information, drawings and specifications are based on the latest published information at the time of printing. Kingfield reserves the right to make changes due to manufacturing improvements and engineering at any time. All physical properties are minimum average values (MAV).